

## Description

SAM-i manual tool is an intelligent system for winding a watch by its crown. The system starts when the nozzle is placed on the crown and pressed.

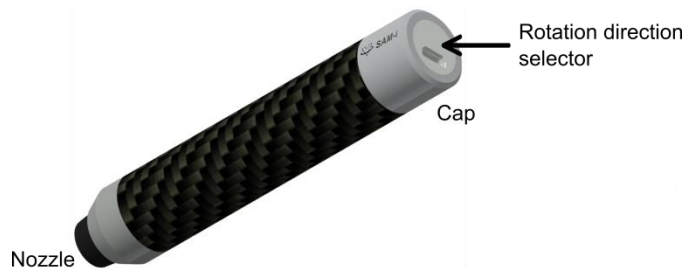

## Use



SAM-i watch winding system in function

## Battery installation (first use)

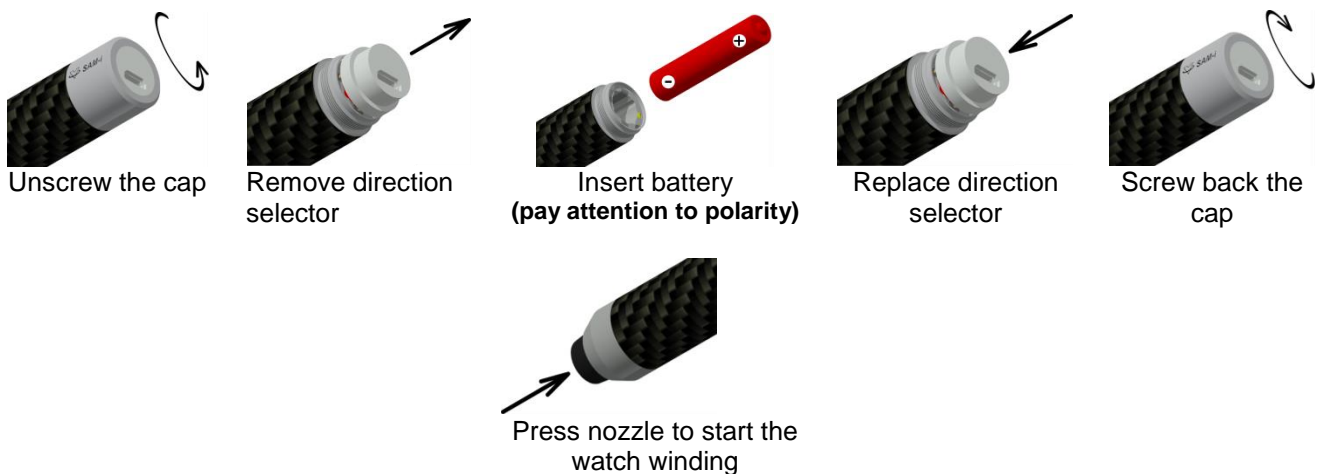

## Rotation direction change

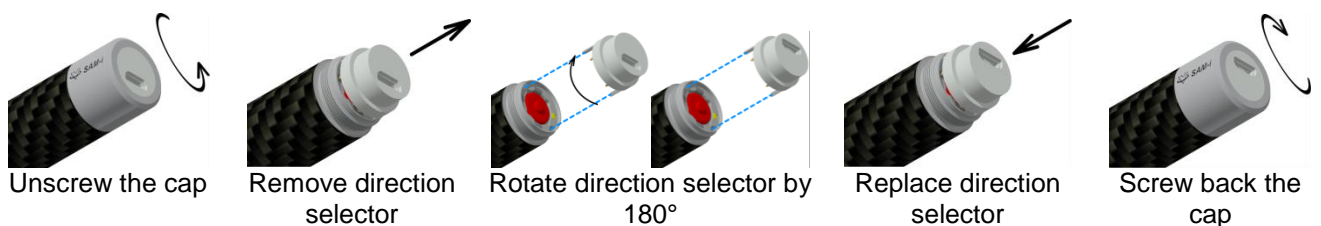

### Meaning of light signalling

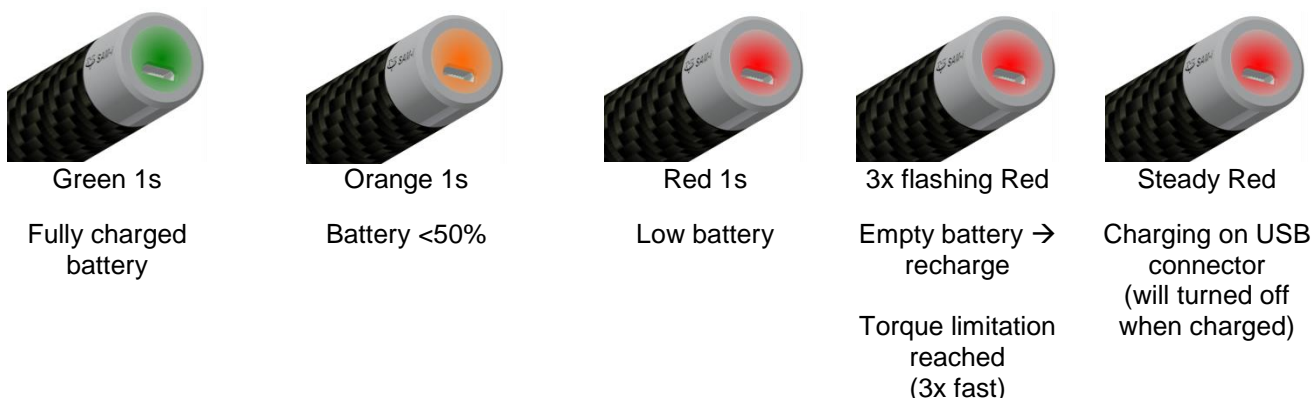

### Nozzle change

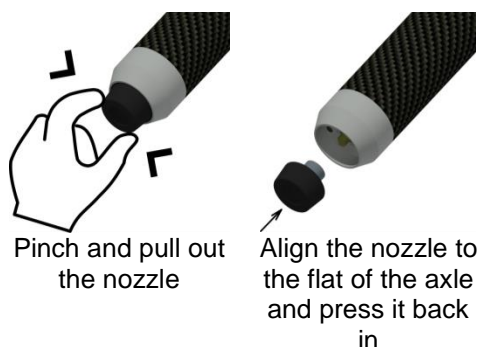

### Technical specifications

Parameters	Values
Rechargeable battery	600mAh/3.7V Protected Li-ion, net weight 11 g
System autonomy	6 months (1 watch winding / day)
Max speed	112 rpm
Torque limiting	18 mNm
Size	Ø 20 x 106 mm
Net weight (excl. battery)	55 g

### China RoHS table

Part	部件名称	Lead (PB)	Mercury (Hg)	Cadmium (Cd)	Hexavalent Chromium (Cr(VI))	Polybrominated biphenyls (PBB)	Polybrominated diphenyl ethers (PBDE)
		有毒有害物质或元素					
		铅	汞	镉	六价铬	多溴联苯	多溴二苯醚
PCB assemblies	电路板组件	0	0	0	0	0	0
Motor	马达	X	0	0	0	0	0
Cassing	壳体	0	0	0	0	0	0
Cables	电缆	0	0	0	0	0	0
Nozzle	管口	0	0	0	X	0	0

O: 代表此种部件的所有均质材料中所含的该种有毒有害物质低于中华人民共和国信息产业部所颁布的

《电子信息产品中有毒有害物质的限量要求》(SJ/T 11363-2006)规定的限量。

X: 代表此种部件所用的均质材料中，至少有一类材料其所含的有毒有害物质高于中华人民共和国信息产业部所颁布的《电子信息产品中有毒有害物质的限量要求》(SJ/T 11363-2006)规定的限量。